



## 2/2 way valve G 1" V-380

### 1. 2/2 way valve G 1" V-380

This 2/2 way valve of simple and robust design can be used in a very large number of applications. Due to its high air flow capacity, it can easily be used, for example, as a discharge valve and in a lot of different applications requiring a two way valve.

The main benefits of this 2/2 way valve are its high air flow capacity, its high reliability and its integrated check-valve function. This avoids any downstream air (outlet 2) to go back if its pressure is higher than the upstream pressure (inlet 1) when the valve is opened.

### 2. Typical application

Amongst many other applications, this 2/2 way valve has specially been designed for rotary and linear stretch blow molding machines. This valve is, however, suitable for many other industrial applications requiring a 2/2 way valve with a large flow capacity and extended lifetime.

### 3. Technical data

|   |  |
|---|--|
| <b>Medium</b><br>Filtered compressed air  | <b>Nominal size</b><br>22 [mm]   |
| <b>Maximum inlet pressure</b><br>40 [bar]   | <b>Inlet port size</b><br>G 1"   |
| <b>Operating temperature</b><br>+ 5 [°C] to +60 [°C]  | <b>Outlet port size</b><br>G 1"  |
| <b>Operating pressure</b><br>3 [bar] to 40 [bar]  | <b>Weight</b><br>2.1 [Kg]  |
| <b>Maximum air flow</b><br>1800 [Nm <sup>3</sup> /h]*<br><small>* Typical air flow with 40 [bar] inlet pressure</small> | <b>Service interval and lifetime</b><br>We recommend servicing the valve every 12 Mio. switching cycles<br>Lifetime typically exceeds 25 Mio. switching cycles |

### 4. Materials

All the materials of the valve which are in contact with the compressed air are intended for use in the food processing machinery.  
The material of the piston is intended for use in contact with food and is FDA compliant.  
The seals in contact with the compressed air are FDA compliant.  
The lubrication (during the assembly) of internal parts is done with grease registered NSF class H1.

**Body:** anodized aluminum

**Piston and seal:** FDA compliant synthetic material

**O-rings:** NBR

**Screws:** Steel, zinc coated

**Retainer ring:** tempered spring steel

### 6. Dimensions

|    |           |
|----|-----------|
| D1 | G 1"      |
| D2 | G 1"      |
| D3 | G 1/8"    |
| L1 | 121 [mm]  |
| L2 | 88 [mm]   |
| L3 | 55.5 [mm] |
| L4 | 30 [mm]   |
| L5 | 44 [mm]   |

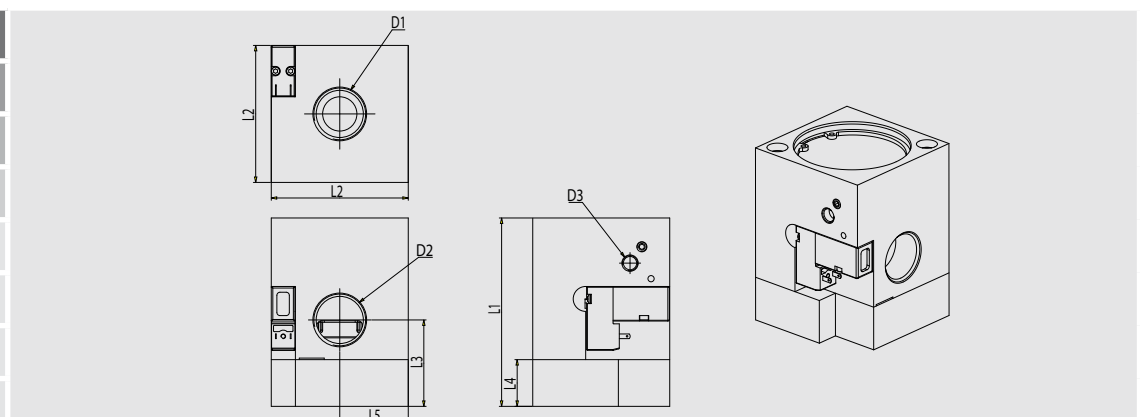

### 5. Pneumatic symbol

